

CM-300L Console-Mount User Station



The CM-300L is a console mount, 2-channel intercom user station. The user station is designed to be used in a full-duplex, conference line intercom system.

Features

- On the CM-300L, a toggle switch turns the microphone on or off. When the mic is turned on one (1) or more users talk and the others listen.
- Volume control on the CM-300L has a wide range to compensate for: user hearing differences, ambient noise variation, variations in headset/handset sensitivity, and variations in voice.
- Channel selector switch allows a choice of 2-channels.
- Call light push button transmits a call signal to all other units on the channel selected by the channel selector switch. A call signal on this channel will cause the call light push button to flash. The flash rate is 2 to 5 times a second. The call signal itself is a 20kHz signal.

Line Drawings

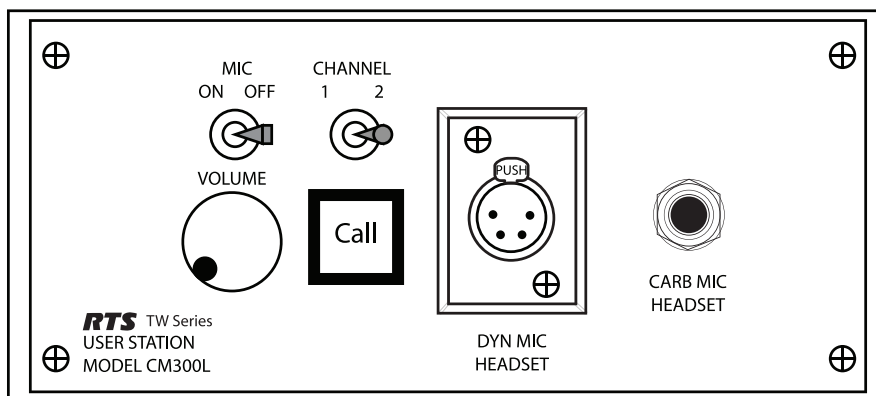

Specifications

Input DC Voltage

TW Mode: 18 to 35VDC

LP Option: 15 to 35VDC

Battery: 12 to 35VDC (reduced performance)

DC Current Drawing from TW Line (Note: LP Option draws no current from TW line)

Quiescent

CM-300/RM-300: 40mA \pm 10%

CM-300/RM-300L: 50mA \pm 10%

Operating 25 Ω headphones

CM-300/RM-300: 60mA \pm 10%

CM-300/RM-300L: 60mA \pm 10%

Operating 25 Ω headphones + Call Light

CM-300/RM-300: 100mA \pm 10%

Impedance Across Line: 10k Ω , minimum

Environmental

Temperature

Operating: 0°C to 50°C (32°F to 120°F)

Storage: -40°C to 85°C (-40°F to 185°F)

Humidity

Operating and Storage: 5% to 95% non-condensing

Noise Contribution

One Unit: -75dBu

Ten Units: -67dBu

Microphone Preamplifier

Input Impedance: 470 Ω /dynamic mic

Source Impedance: 200 Ω , nominal

Maximum Input Level: 150mV

Frequency Response: 100Hz to 10kHz \pm 3dB (-54dBu input)

Limiter Range: 30dB

Carbon Mic Excitation Current: 10mA, nominal

Current Source

Output: \pm 5mA into 200 Ω = \pm 1 volt peak, nominal

Headphone Amplifier

Voltage Gain: 34dB

Output Voltage: 8 volts peak-to-peak into 25 Ω

Output Power: ½ watt peak into 25 Ω

Frequency Response: 150Hz to 8kHz \pm 3dB

Headphone Impedance Range: 25 to 600 Ω (600 to 2k Ω with reduced levels)

Note: Do not use headphones with impedance less than 25 Ω .

Sidetone Adjustment Range: 20dB

Call-Light

Signaling Frequency: 20kHz \pm 100Hz

Flashing Rate: 5Hz \pm 2Hz

Auxiliary Connections

Headset Connector

Dynamic Microphone: XLR type 4-pin female

Carbon Microphone: ¼" standard phone jack, 3-circuit

Line Connection

Input: XLR type 3-pin female

Loop/External: XLR type 3-pin female

Mechanical (CM-300/CM-300L)

Dimensions: 2.75" (69.9mm) H, 6.25" (158.75mm) W, 6.4" (162.6mm) D

Weight: 1.2lbs (0.55kg)

Finish: Front panel light gray enamel paint,

Chassis: Gold Iridite over aluminum

Order Information

CM300L A4F • CM-300L A4F • 2-channel console mount user station with an A4F headset connector

CM300L A5F • CM-300L A5F • 2-channel console mount user station with an A5F headset connector

The specification information is preliminary and is subject to change without notification.
Brand names mentioned are the property of their respective companies.